

## Handrail Industry

*Loxreen*  
METALSOURCE®

# THE *Lovreen* COMPANY, INC.

## HAND RAIL INDEX

AA011455	_____	13
AA011456	_____	13
AA011457	_____	13
AA011526	_____	10
AA011527	_____	10
AA018816	_____	5
AA019111	_____	14
AA019277	_____	15
AA019908	_____	6
AA019909	_____	6
AA019910	_____	6
AA019982	_____	9
AA020293	_____	4
AA020294	_____	4
AA020295	_____	4
AA020645	_____	10
OA099020	_____	1
OA099021	_____	1
OA099022	_____	1
OA099023	_____	1
OA099024	_____	1
OA099025	_____	2
OA099026	_____	2
OA099027	_____	2
OA099028	_____	2
OA099029	_____	3
OA099030	_____	3
OA099031	_____	3
OA099032	_____	4
OA099033	_____	4
OA099035	_____	4
OA099038	_____	5
OA099039	_____	7
OA099040	_____	7
OA099041	_____	7
OA099042	_____	7
OA099043	_____	8
OA099044	_____	8
OA099045	_____	9
OA099046	_____	9
OA099047	_____	9
OA099048	_____	11
OA099049	_____	12

**HAND RAIL**  
Mechanical System

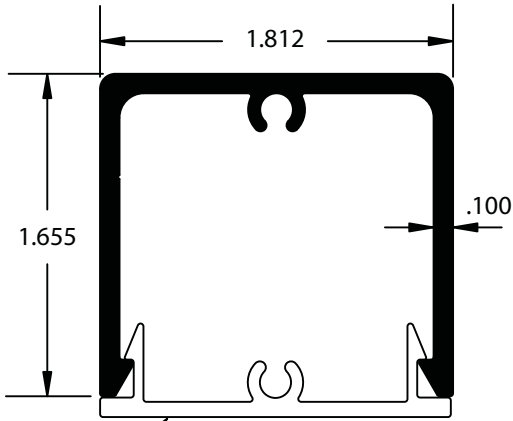

OA099022  
mating part  
**OA099020 Post Channel**

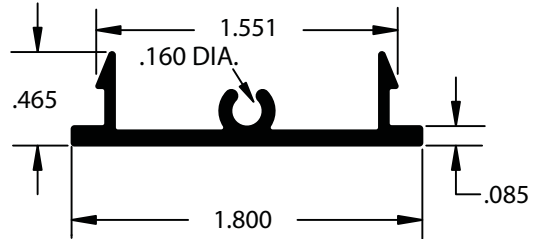

**OA099022 Snap Plate**

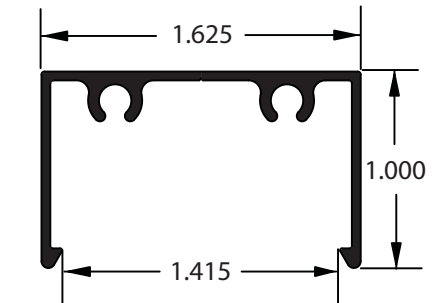

**OA099023 Bottom Channel**

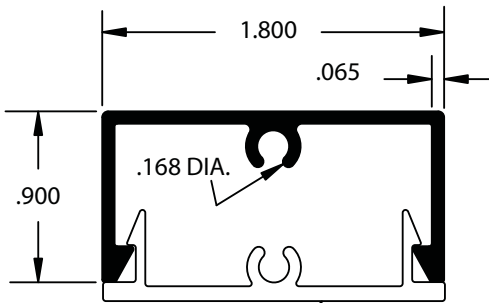

OA099022  
mating part  
**OA099021 Bottom Channel**

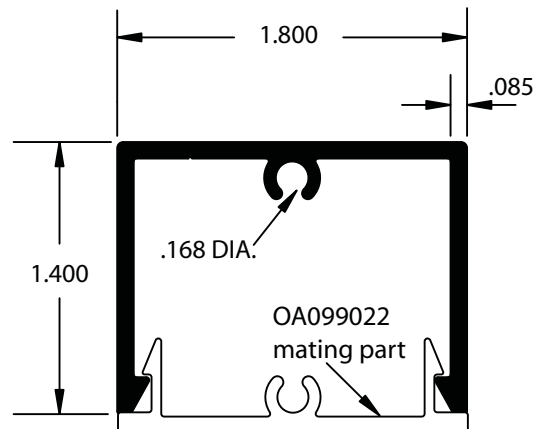

**OA099024 Medium Bottom Channel**

Available in AE, Paint, Kynar, Clear Anodize, Bronze Anodize and special colors.

www.loxscreen.com  
All shapes are shown in actual size.  
21' length standard

HAND RAIL  
Mechanical System

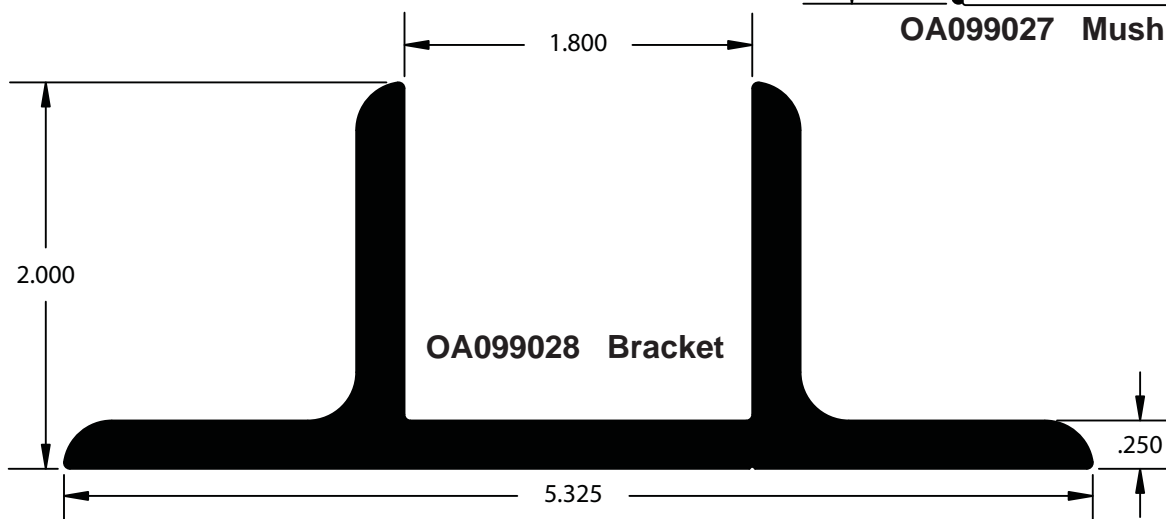
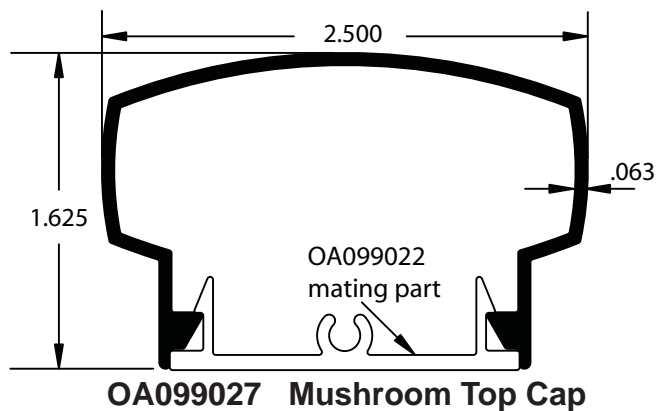
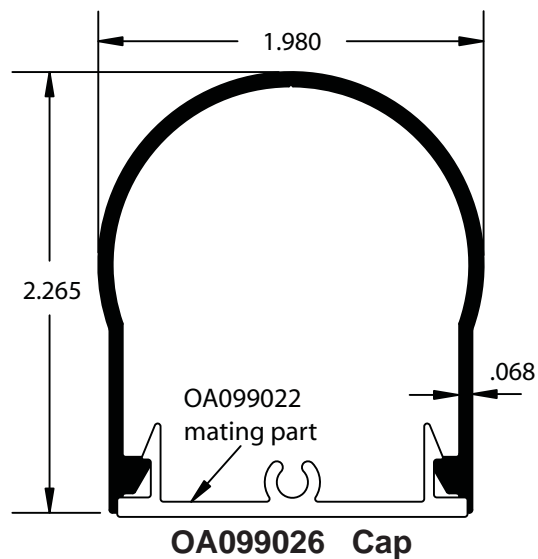
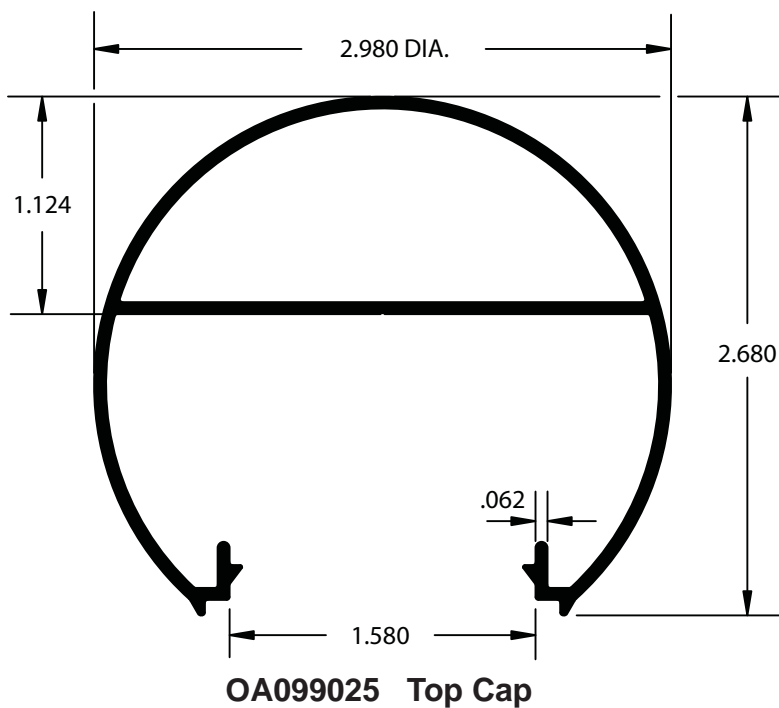

www.loxscreen.com  
All shapes are shown in actual size.  
21' length standard

HAND RAIL  
Mechanical System

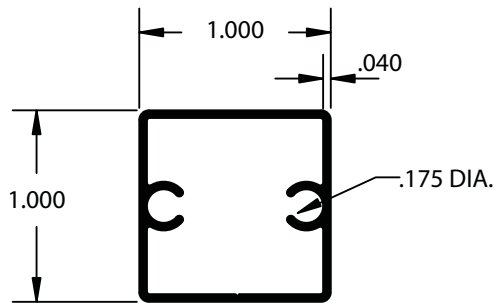

**OA099029 1" Square Picket  
w/Screw Bosses**

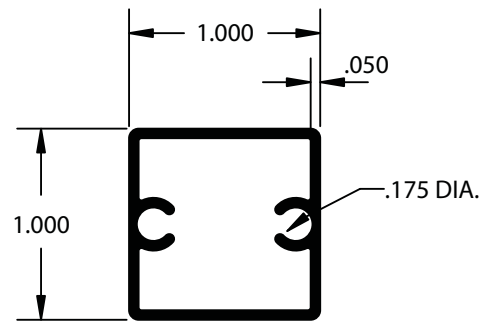

**OA099030 1" Square Picket  
w/Screw Bosses**

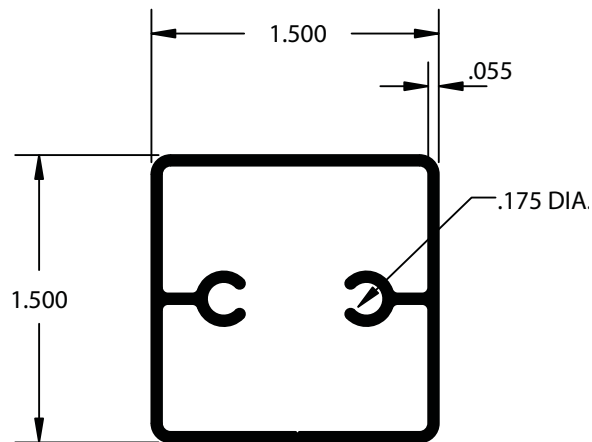

**OA099031 1.5" Square Picket w/Screw Bosses**

www.loxscreen.com  
All shapes are shown in actual size.  
21' length standard

**HAND RAIL**

Welded / Mechanical System

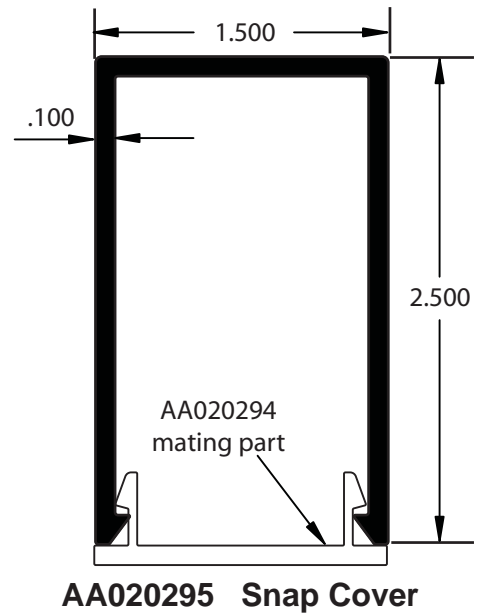
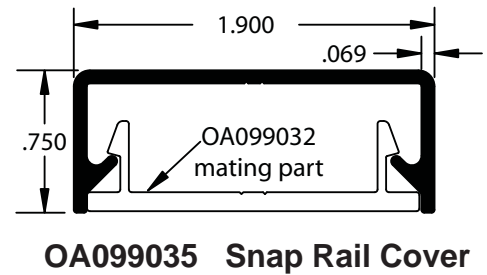
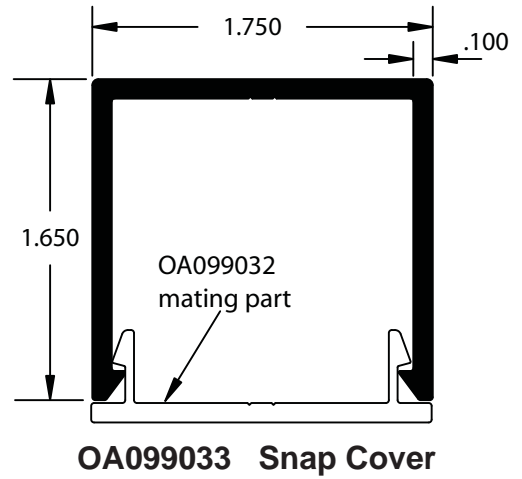
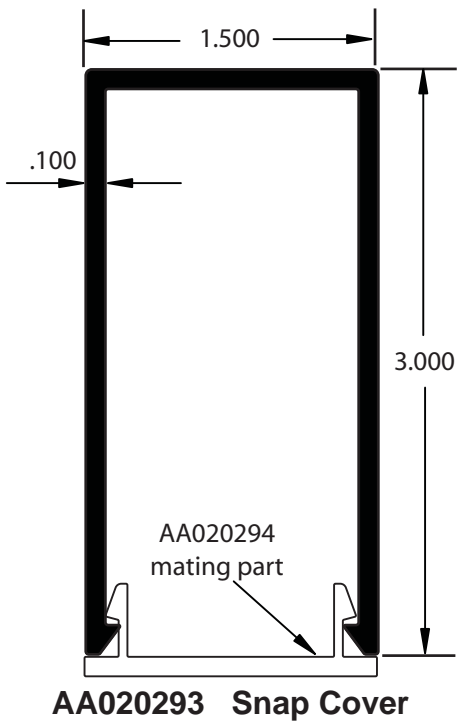
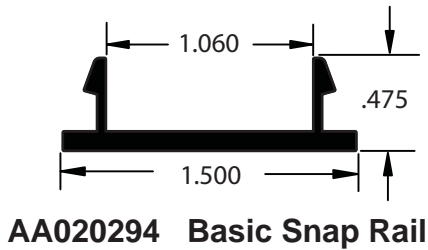
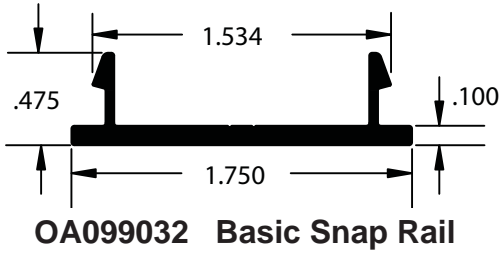

Available in Mill (AE) finish only.

www.loxscreen.com  
All shapes are shown in actual size.  
21' length standard

**HAND RAIL**  
Welded / Mechanical System

---

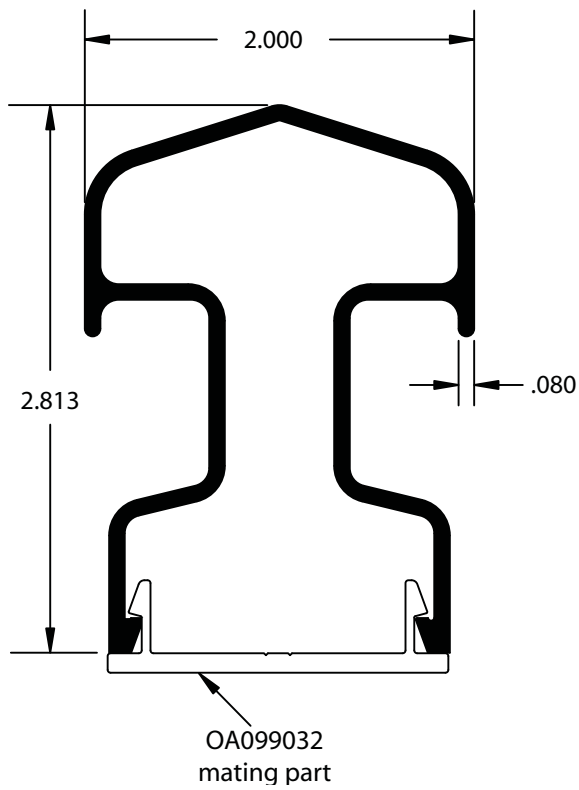

**AA018816 Top Rail**

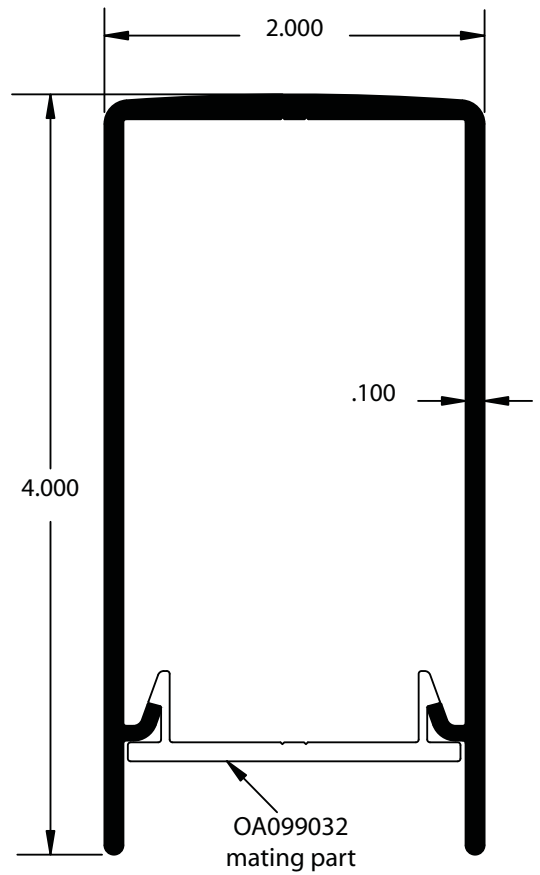

**OA099038 Rail**

www.loxcreen.com  
All shapes are shown in actual size.  
21' length standard

**HAND RAIL**

Welded / Mechanical System

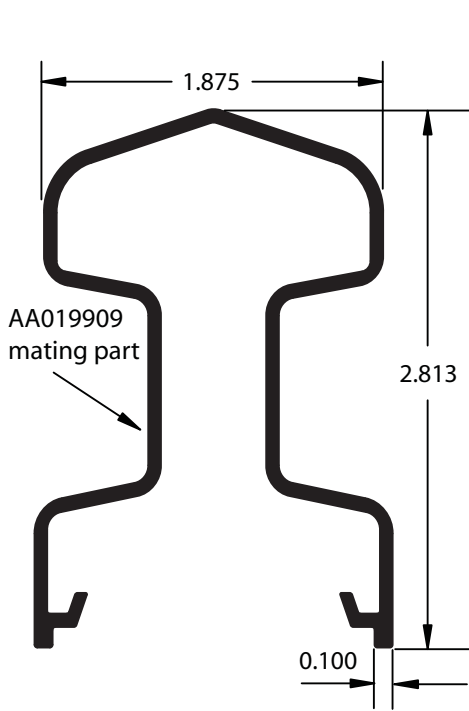

**AA019908 Graspable Grab Rail**

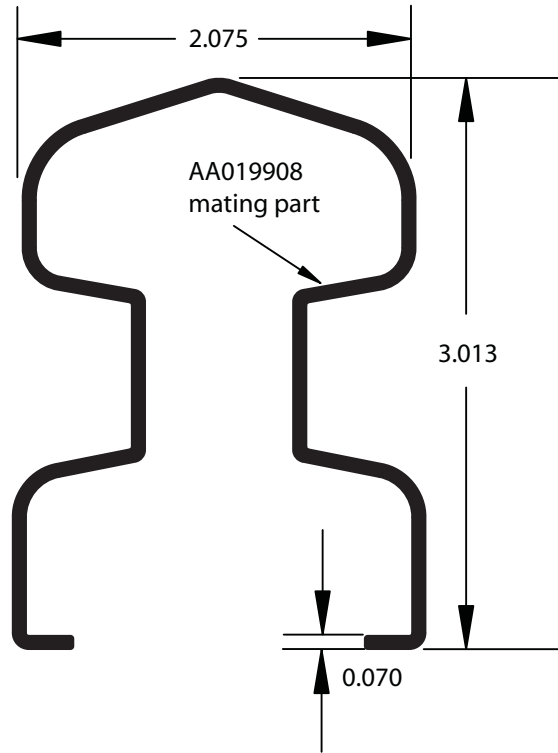

**AA019909 Sleeve Graspable Grab Rail**

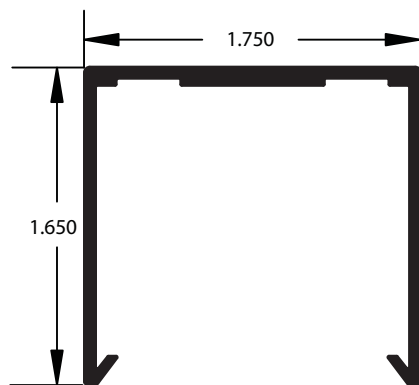

**AA019910 Modified Snap Cover**

www.loxcreen.com  
All shapes are shown in actual size.  
21' length standard

**HAND RAIL**

Welded / Mechanical System

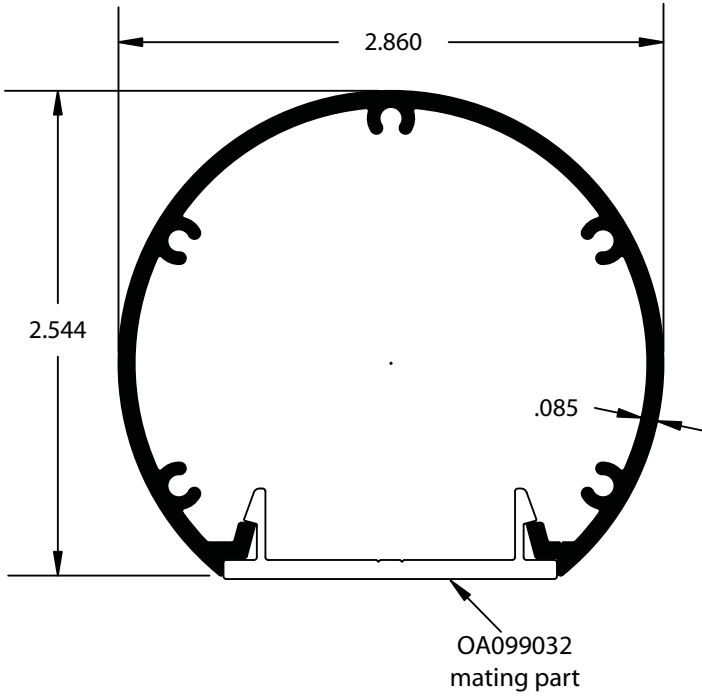

**OA099039 Round Hand Rail**

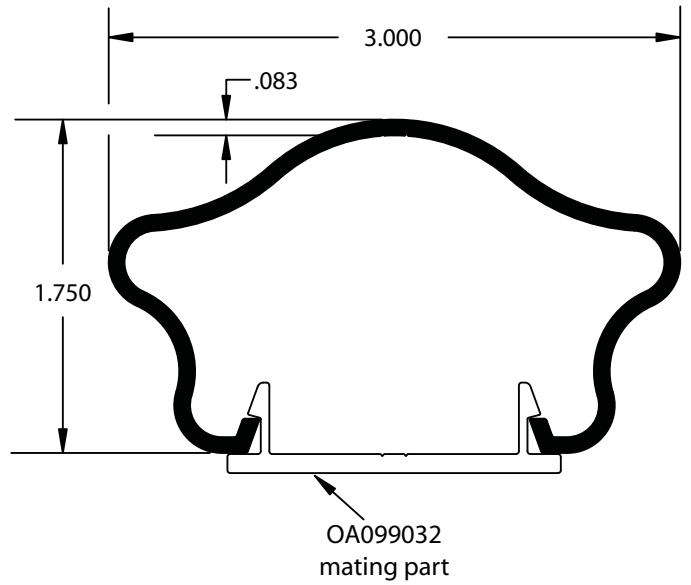

**OA099040 Top Rail**

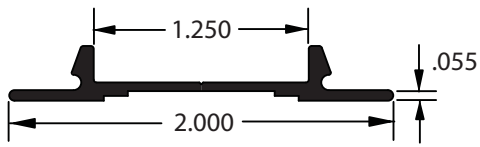

**OA099042 Snap Rail**

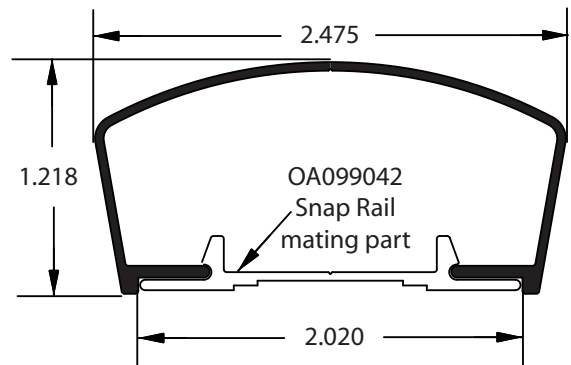

**OA099041 Top Rail**

www.loxreen.com  
All shapes are shown in actual size.  
21' length standard

HAND RAIL  
Welded System

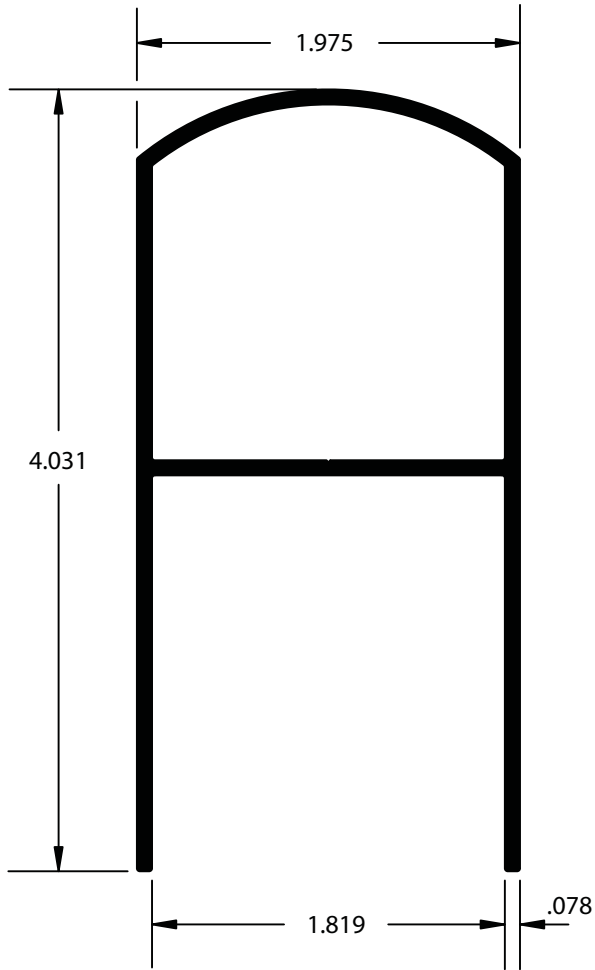

**OA099043 Top Cap**

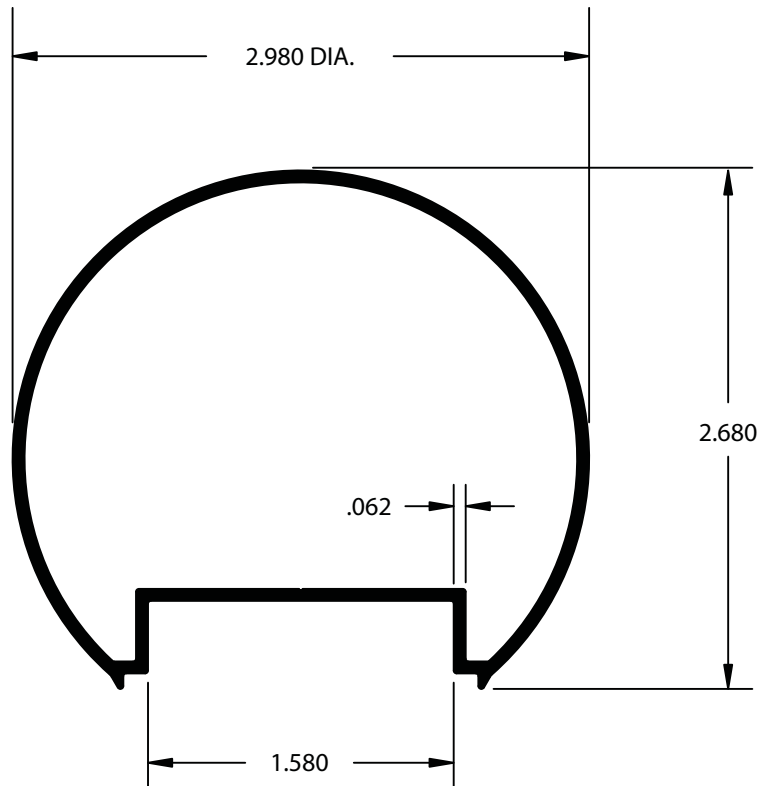

**OA099044 Top Cap**

www.loxcreen.com  
All shapes are shown in actual size.  
21' length standard

**HAND RAIL**  
Welded System

---

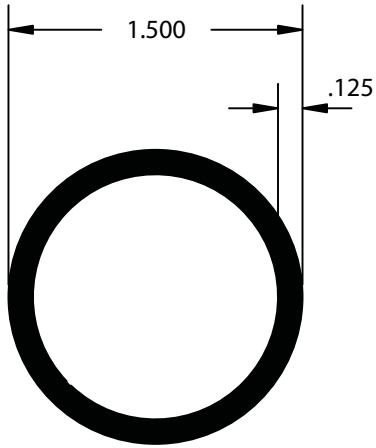

**OA099045 Hand Rail**

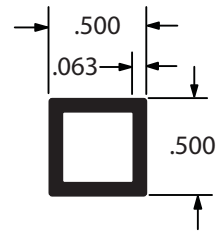

**AA019982 Square Tube**

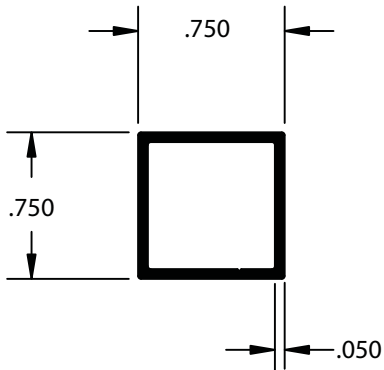

**OA099046 Picket**

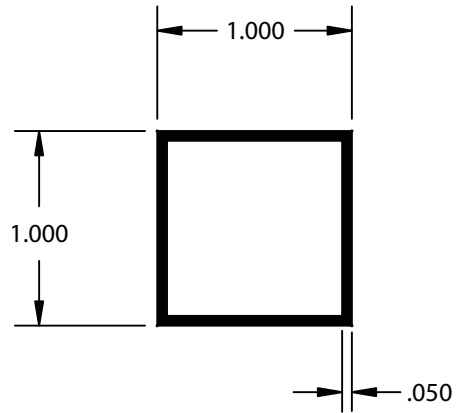

**OA099047 Square Tube**

www.loxcreen.com  
All shapes are shown in actual size.  
21' length standard

**HAND RAIL**  
Welded System

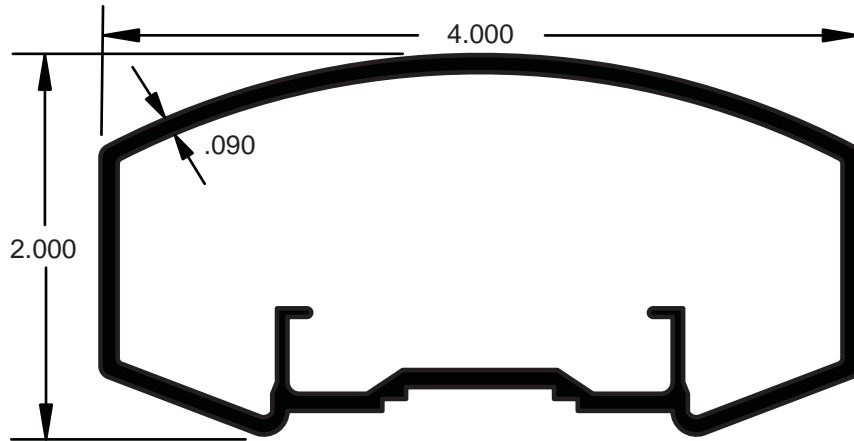

**AA020645 Top Rail**  
Accepts 3/4" or 1" picket

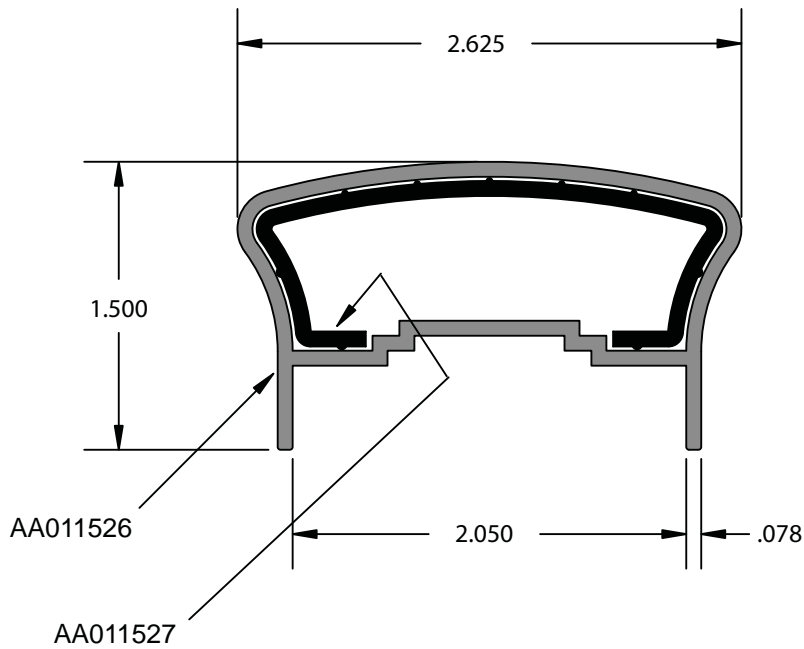

**Cap with Internal Splice**  
Accepts 1/2" and 3/4" pickets

www.loxcreen.com  
All shapes are shown in actual size.  
21' length standard

HAND RAIL  
Welded System

---

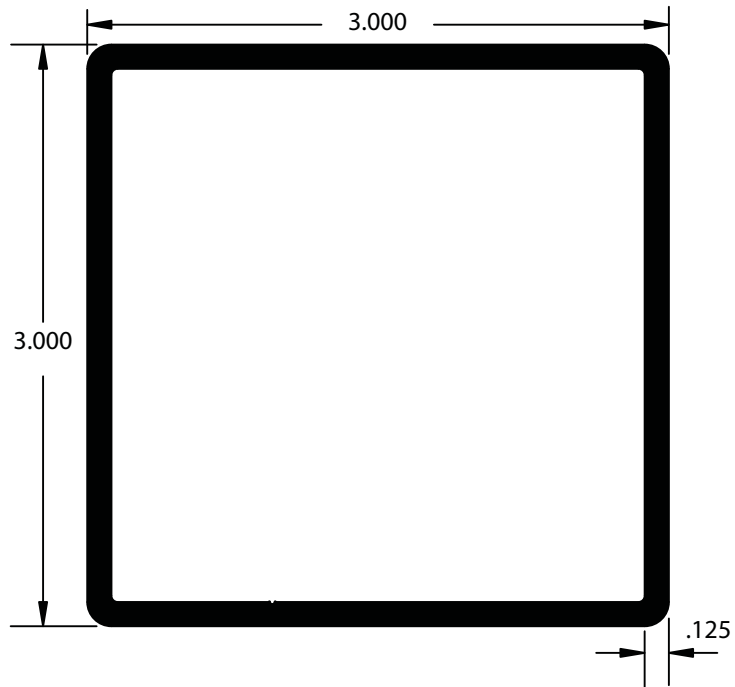

**OA099048 3" Tube with Radius Corners**

www.loxreen.com  
All shapes are shown in actual size.  
21' length standard

HAND RAIL  
Miscellaneous

---

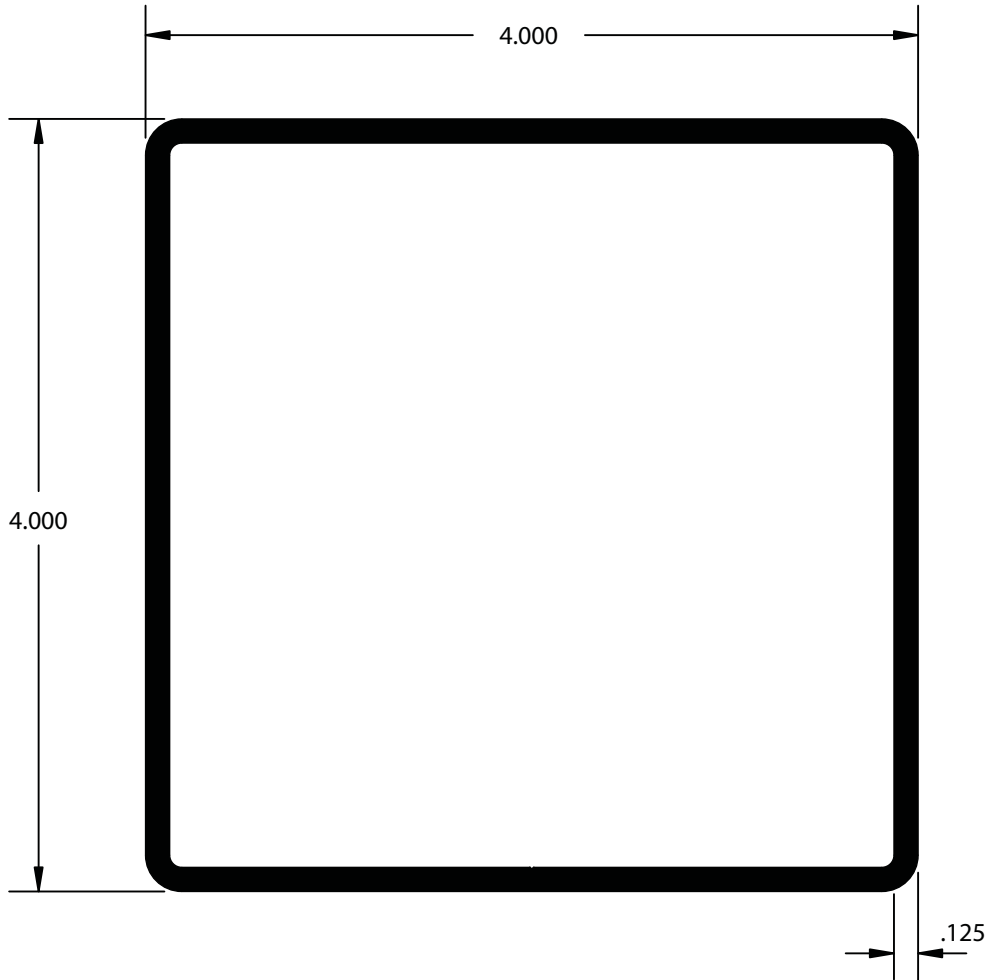

**OA099049 4" Tube with Radius Corners**

www.loxcreen.com  
All shapes are shown in actual size.  
21' length standard

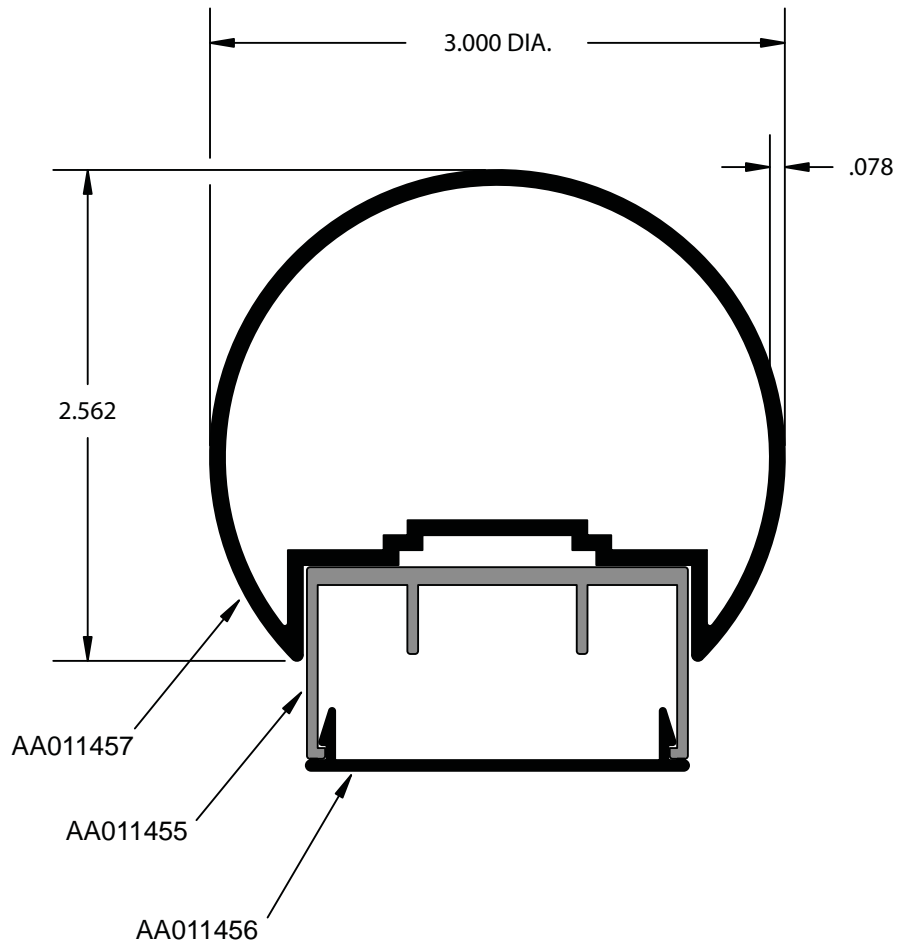

**Cap with Bottom Channel and Snap Plate**  
Accepts 1/2" and 3/4" pickets

www.loxcreen.com  
All shapes are shown in actual size.  
21' length standard

HAND RAIL  
Miscellaneous

---

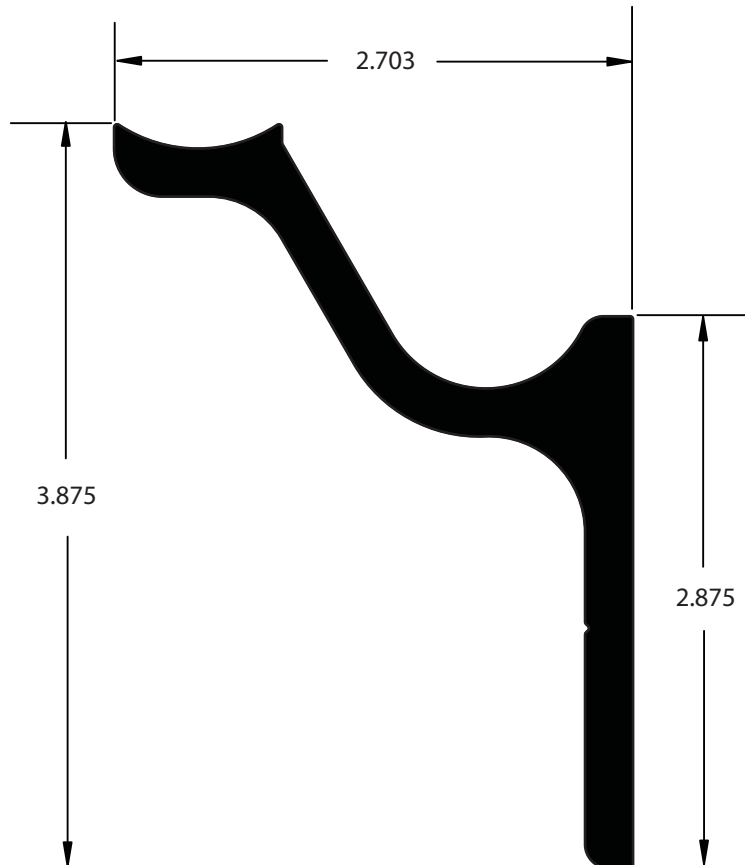

**AA019111 Rail Bracket**

www.loxcreen.com  
All shapes are shown in actual size.  
21' length standard

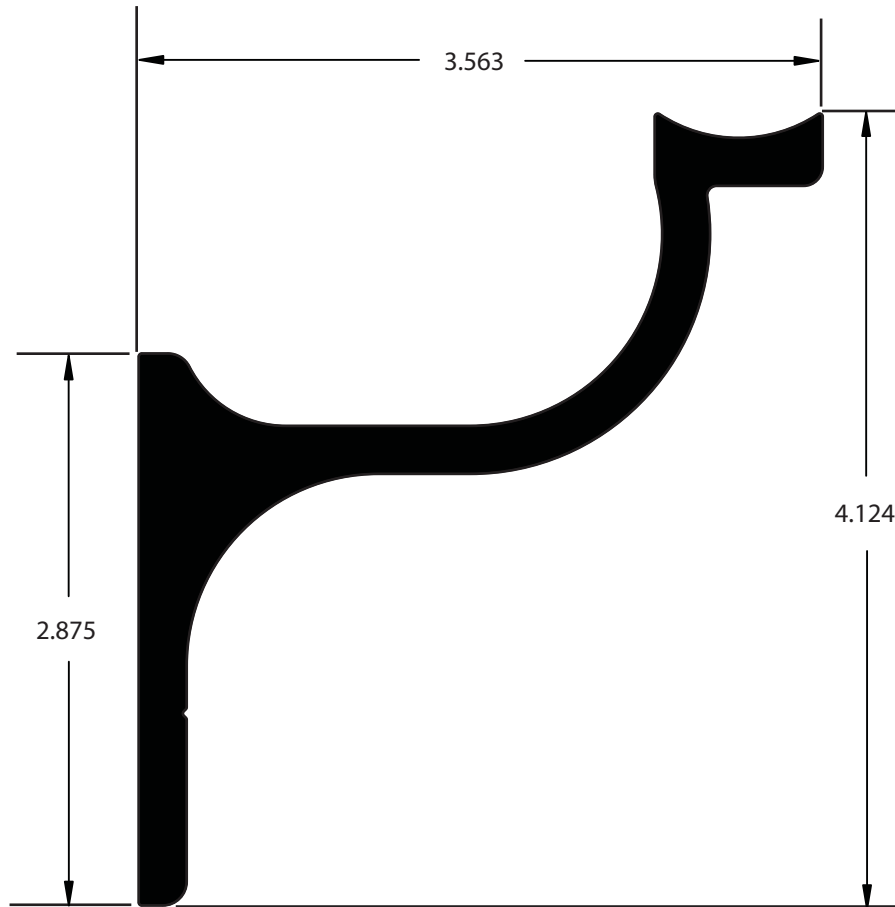

**AA019277 Handrail Bracket**

www.loxcreen.com  
All shapes are shown in actual size.  
21' length standard

# Terms & Conditions

**1. CONTRACT BETWEEN BUYER AND SELLER:** A written order and acknowledgment shall constitute the contract between Buyer and Seller, and said Contract may not be amended or rescinded except by written agreement by both parties, referring expressly to this contract.

**2. WARRANTY:** Seller warrants that merchandise sold to Buyer shall be free from defects in material and workmanship and shall conform to specifications. **EXCEPT FOR SUCH WARRANTY, THE SELLER DISCLAIMS ANY AND ALL OTHER WARRANTIES OF ANY KIND WHATSOEVER, INCLUDING WITHOUT LIMITATION, ANY WARRANTY OF MERCHANTABILITY OR FITNESS FOR PARTICULAR PURPOSE AND INCLUDING BUT NOT LIMITED TO ANY ORAL OR WRITTEN DESCRIPTION OF THE PRODUCTS, THEIR CHARACTERISTICS OR PROPERTIES OTHER THAN THAT SPECIFICALLY STATED IN THE FOREGOING LIMITED WARRANTY. SELLER SHALL HAVE NO LIABILITY FOR CONSEQUENTIAL OR INCIDENTAL DAMAGES AS A RESULT OF THE SALE OF ITS MERCHANDISE.** In the event that its merchandise is not as warranted, Buyer's sole remedy will be, at Seller's election, replacement of the merchandise or return of the purchase price. Prior written approval from the Seller must be secured before returning any merchandise for credit.

**3. TOLERANCES:** Standard Commercial tolerances apply unless otherwise specified.

**4. PRICE:** Prices are based on existing conditions and are subject to change, at our discretion, at any time prior to order shipment. Unless otherwise specified, all prices are based on quantity shipped per release, with Buyer accepting over-run or under-run on each individual item based on standard shipping tolerances. Exact control of quantity shipped must be specified as a requirement of said contract.

**5. CREDIT:** All shipments shall be subject to the approval of Seller's Credit Department. If, in the sole judgment of the Seller, the financial responsibility of the Buyer is unsatisfactory, or becomes impaired, or if Buyer fails to make any payment in accordance with the terms of the contract, then Seller may defer or decline to make any shipments except upon receipt of satisfactory security or cash payments in advance, or Seller may terminate the contract.

**6. TAXES:** All prices are subject to the net additions of all Federal, State, or Municipal taxes or charges which may be established or levied upon or assessed against the merchandise under contract.

**7. SHIPMENTS:** Unless otherwise specified, title to all merchandise, and the risk of loss, shall pass to the Buyer upon delivery by the Seller to the transportation carrier at the shipping point or the actual transfer of possession to the Buyer, whichever is earlier.

**8. DELAYS:** Seller cannot be held liable for loss or damage arising from delay in fulfilling or failure to fulfill any accepted order in accordance with its terms where such delay or failure is caused by shortage of materials, delays of carriers, embargoes, fires, floods, strikes, riots, wars, acts of God, or other causes beyond our control.

**9. RETURNED MATERIAL AUTHORIZATION:** Seller must be notified within 10 days after delivery of Buyer's request to return merchandise. Upon receipt of Seller's authorization, merchandise must be returned within 30 days in accordance with Seller's shipping instructions. Merchandise must be returned in exactly the same condition as in which it was received by Buyer. Handling and restocking fees will be charged to Buyer's account.

**10. CANCELLATION:** Said contract is subject to cancellation only upon Seller's acceptance of such cancellation in writing and the effective date of cancellation shall be the date of such acceptance. Payment of cancellation charges shall be made by Buyer upon receipt of statement of same. Cancellation charges shall not exceed the purchase price of the canceled portion of the contract.

**11. EQUIPMENT:** Any equipment (including jigs, process dies and tools, etc.) which Seller constructs or acquires specifically for use on Buyer's order shall be the sole property of Seller, whether or not they are charged to Buyer's account. Die charges are for exclusive use of extrusion tooling and are not subject to refund. Dies which indicate no activity for two years or more will be scrapped without notice and replacement cost will be for Buyer's account.

**12. PATENT PROTECTION:** Seller agrees to indemnify Buyer against any claims or liabilities for or by reason of alleged patent infringement arising from the manufacture or sale of any merchandise furnished Buyer hereunder, except where the specifications, process, design or method of manufacture originated with Buyer, in which event Buyer agrees to indemnify Seller in like manner.

# THE *Loxcreen* COMPANY, INC.

---

Contact our Service Center near you for more information on LOXCREEN Products.

## Corporate Office

---

1630 Old Dunbar Road / PO Box 4004 (29171) / West Columbia, South Carolina 29172  
(803) 822-8200 / FAX (803) 822-8547  
[www.loxcreen.com](http://www.loxcreen.com)

## Loxcreen METALSOURCE®

---

### TEXAS

400 N. Great SW Parkway / Arlington, Texas 76011 / Metro 640-4456  
All other areas (817) 649-2771 / FAX (817) 649-1760 / 800-222-4629

### MISSOURI

PO Box 528 / 800 South Pemiscot Street / Hayti, MO 63851 / (573) 359-2811 / FAX (573) 359-2814  
800-323-8314

### OHIO

100 Westheimer Drive / Middletown, Ohio 45044 / (513) 539-2255 / FAX (513) 539-2288  
800-432-4672

### SOUTH CAROLINA

PO Box 4004 / West Columbia, SC 29171-4004 / 1630 Old Dunbar Road / West Columbia, SC 29172  
(803) 822-1600 / FAX (803) 822-8070 / 800-845-0840  
Customer Service location  
800-682-9586 / FAX (336) 597-8821

SOME ITEMS MAY NOT BE CARRIED IN STOCK.  
PRICES ARE AVAILABLE UPON REQUEST.